



# SHREE CEMENT LIMITED

(UNIT-SHREE RAIPUR CEMENT PLANT)

Village: Khaparadih, Tehsil: Simga, Distt. Baloda Bazar-Bhatapara (C.G) Pin: 493332,  
Ph.:07727-203101, CIN No. : L26943RJ1979PLC001935



SRCP/ENV/2022-23/132

Date: 26/11/2022

To,  
The Member Secretary,  
State Environment Impact Assessment Authority  
Paryavas Bhavan, North Block, Sector-19  
Naya Raipur (C.G)

**Sub:** Submission of Half Yearly compliance report of Environmental Clearance for Township of Shree Raipur Cement Plant (A unit of Shree Cement Ltd.) located at Village - Bharuwadih, Tehsil - Balodabazar, District - Balodabazar - Bhatapara (Chhattisgarh) for the period from April 2022 to September 2022.

**Ref:** - EC Letter No. 1218/S.E.I.A.A., C.G./Residential project/B.B./2147, New Raipur dated 22/12/2016.

Dear Sir,

With reference to the above subject, we are submitting herewith Six Monthly Environment Clearance (EC) compliance status report of Township of Shree Raipur Cement Plant (A unit of Shree Cement Ltd.) located at Village - Bharuwadih, Tehsil - Balodabazar, District - Balodabazar - Bhatapara (Chhattisgarh) for the period from April - 2022 to September - 2022.

Submitted for your kind information and record please.

Thanking you

Yours faithfully  
For Shree Raipur Cement Plant  
(A unit of Shree Cement Ltd.)

  
I.V. Mahesh  
Asst. Vice President

Encl.- As above

CC to: -

1. The In charge (Zonal Office), Central Pollution Control Board (CPCB), Parivesh Bhawan, Paryavaran Parisar E-5, Arera Colony, Bhopal-462016.
2. The Member Secretary, Chhattisgarh Environment Conservation Board, Paryavas Bhavan, North Block, Sector-19 Nawa Raipur, Atal Nagar (C.G).
3. The Regional Officer, Chhattisgarh Environment Conservation Board, Commercial Complex, Chhattisgarh Housing Board Colony, Kabir Nagar, Raipur (C.G.) - 492099.
4. Integrated regional Office, Aranya Bhawan, North Block, Sector-19, Naya Raipur, Atal Nagar, Chhattisgarh.

**SIX MONTHLY COMPLIANCE REPORT OF ENVIRONMENT CLEARANCE (EC)**

*For*

**Township of Shree Raipur Cement Plant (A unit of Shree Cement Ltd.)**

*at*

**Village - Bharuwadih, Tehsil - Balodabazar,  
District – Balodabazar - Bhatapara (Chhattisgarh).**

*Submitted to:*

**Integrated Regional Office, Raipur  
Ministry of Environment, Forests & Climate Change,  
Central Pollution Control Board, Bhopal &  
Chhattisgarh Environment Conservation Board, Raipur**



**SHREE CEMENT LIMITED**

*by:*

**ENVIRONMENT MANAGEMENT DEPARTMENT**

**PERIOD: APRIL - 2022 – SEPTEMBER - 2022**

**SRCP Colony Environment Compliance Status report**

**Period from April - 2022 to September -2022**

<b>Name of Project:</b>	SRCP Colony Shree Raipur Cement Plant (A unit of Shree Cement Ltd)
<b>Capacity &amp; Location:</b>	SRCP Colony (residential Colony) Total Colony area 220854 sq. meter (22.085 ha) and buildup area-110111 sq. meter at Village – Bharuwadih, Distt. - Balodabazar - Bhatapara (Chhattisgarh).
<b>EC letter No.:</b>	1218/S.E.I.A.A., C.G./Residential project/B.B./2147, New Raipur dated 22/12/2016.

<b>Sr. No</b>	<b>Conditions</b>	<b>Compliance Status</b>
<b>I</b>	<b><u>Construction Phase</u></b>	
	<b><u>Facility of Laborers during construction</u></b>	
i)	Construction camp and temporary labor sheds shall be located away from the construction site. Construction camps shall be provided for construction personnel to avoid indiscriminate settlement of construction workers and laborers.	Being Complied. Construction camp and temporary labor sheds are located away from the construction site. Construction camps are provided for construction personnel to avoid indiscriminate settlement of construction workers and laborers.
ii)	Provision to drinking water, waste water disposal, solid wastes management and primary health facilities shall be ensured for labour camps. Proper sanitation facilities shall be provided at the construction site to prevent health related problem. Domestic as well as sanitary wastes from construction camps shall be cleared regularly. Provision shall be made for mobile toilets. The safe disposal of wastewater and solid wastes generated during construction phase shall be ensured.	Being Complied. Provision to drinking water, wastewater disposal, solid wastes management and primary health facilities are being ensured for labour camps. Proper sanitation facilities have been provided at the construction site to prevent health related problem. Domestic as well as sanitary wastes from construction camps are cleared regularly.
iii)	Water usage during construction shall be optimized to avoid any wastage.	Being Complied. Water usage during construction is being optimized to avoid any wastage.
iv)	Adequate safety measures shall be adopted to the construction workers.	Being Complied. Adequate safety measures have been adopted.
v)	All the labourers to be engaged for construction works shall be screened for health and adequately treated before issue of work permits. The contractor shall ensure periodic health check-up of construction workers. A first Aid room shall be provided in the project both during construction and operation of the project.	Being Complied. Medical facilities are available.
vi)	Provision shall be made for the supply of kerosene or cooking gas/pressure cooker to the labourers during construction phase.	Being Complied.

	<b><u>Environmental Management During Construction :-</u></b>	
i)	As far as practicable re-use of debris of demolished existing buildings/houses/structures at existing site is recommended with a special care for handling and disposal of asbestos waste if any. Rest of waste is to be disposed at the sanitary landfill disposal site.	Not Applicable. There is no Demolition, asbestos and other wastes generated from the construction site.
ii)	Appropriate measure like adequate drainage, embankment construction and slope stabilization shall be taken along the roads to avoid soil erosion. Top soils (20 cm) of the borrow pit sites shall be conserved and restored after completion of excavation. All the topsoil excavated during construction activities shall be stored for use in horticulture/landscape development within the project site. Proper erosion control and sediment control measures shall be adopted.	Being Complied. The top soil generated have been used for plantation purpose.
iii)	Earth material generated from excavation shall be reuse to the maximum possible extent as filling material during site development. The construction debris and surplus excavated material shall be disposed-off by mechanical transport in suitable pre-identified dumping areas to avoid land degradation and water logging due to indiscriminate dumping. Dumping areas shall be biologically reclaimed through topsoil cover and plantation.	Being Complied. Earth material generated from excavation is being reused as filling material at the site development.
iv)	A soil erosion and sedimentation control plan shall be prepared prior to construction. The soil erosion sediment control and storm water practices shall be incorporated depending upon the site characteristics to control soil erosion and loss of topsoil during construction.	Being Complied. There is no any soil erosion envisaged from the site however 8,500 Nos. of tree sapling have been planted at SRCP Colony.
v)	Disposal of muck including excavated material during construction phase shall not create any adverse effects on the neighboring communities and disposed-off taking the necessary precautions for general safety and health aspects.	Being Complied.
vi)	Low Sulphur diesel type diesel generator sets should be used during construction phase. Diesel generator sets during construction phase shall have acoustic enclosures and shall conform to Environment (Projection) Rules, 1986 prescribed for air and noise emission standards.	Being Complied. Installed DG fitted with acoustic enclosure and confirming the standards prescribed for noise and air emission.
vii)	All Vehicles/equipment's deployed during construction phase shall be ensured in good working condition and shall conform to applicable air and noise emission standards. These shall be operated only during non-peaking hours.	Being Complied. Regular maintenance of Vehicles/equipment's deployed during construction phase is being done to control the noise level and vehicles only having PUC certificate are deployed.
viii )	Ambient noise levels shall conform to residential standards both during day and night. Incremental pollution loads on the ambient air and noise quality shall be ensured during construction phase. Equipment noise levels shall be ensured during construction phase and closely monitored during construction phase. Adequate measures shall be provided to	Being Complied. Vehicles are maintained in good condition with proper oil and greasing to control unwanted noise pollution. Noise & Ambient Air Monitoring being done. Reports of Continuous Ambient Air Quality

maintain ambient air quality and noise levels during construction phase, so as to conform to the stipulated standards by CPCB/CECB. Fortnightly monitoring of ambient air quality (PM10, PM2.5, SO2 and NOX) shall be done.

monitoring are enclosed as **Annexure – I**.

**Annexure – I**

Continuous Ambient Air Quality Monitoring Report (Monthly Average Values) ( $\mu\text{g}/\text{m}^3$ )								
Location	Parameter	Norms	Monitoring Period					
			Apr-22	May-22	Jun-22	Jul-22	Aug-22	Sep-22
Village Bharuwadih	PM10	100	51.83	58.91	46.96	28.40	21.57	29.41
	PM2.5	60	29.01	24.23	20.32	11.50	14.38	18.33
	SO2	80	13.69	13.80	13.86	13.69	14.10	13.94
	NO2	80	16.50	4.73	4.91	5.25	5.24	5.24

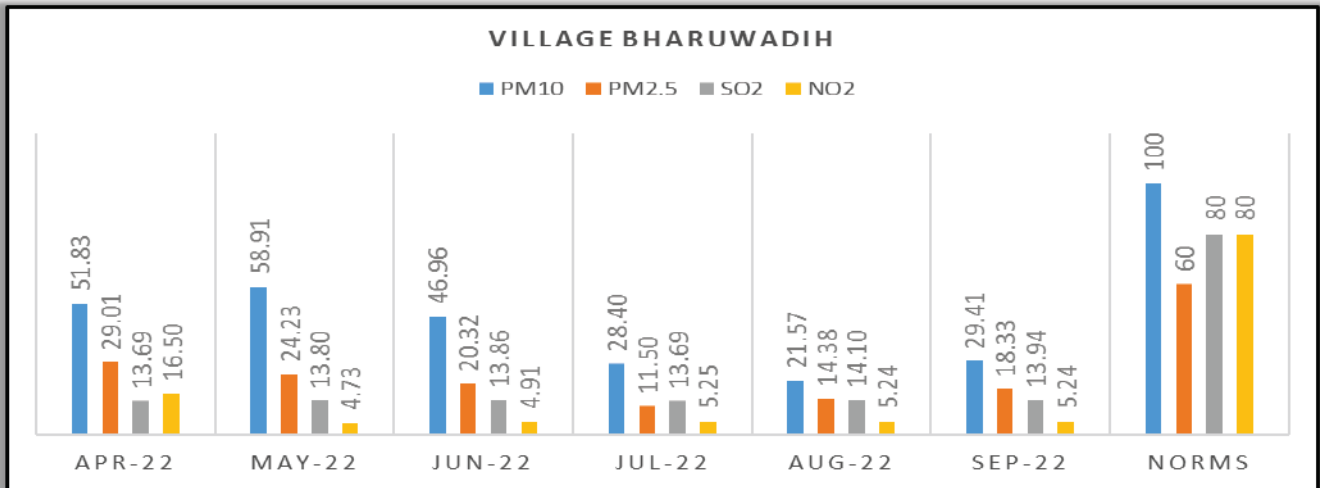

ix) The protective equipment's such as earplugs etc. Shall be provided to construction personnel exposed to high noise levels. Stationary construction equipment's generating noise shall be placed away from inhabited areas and silence zones. Construction activities carried out near residential area shall be scheduled to daytime only. Only limited necessary construction shall be done during night time. No unloading of construction materials shall be done at night. Vehicular noise and use of horns shall be controlled through enforcement of laws and public awareness. Use of pressure horns shall be strictly prohibited. To reduce noise level, the roads shall be designed to have more rows of plantation.

Being Complied.  
The protective equipment's such as earplugs etc. are being provided to construction personnel exposed to high noise levels

x) Construction spoils, including bituminous material and other hazardous materials including oil from construction equipment's must not be allowed to contaminate watercourses and the dumpsites for such material must be secured so that they shall not leach into the ground water. If necessary, oil trap shall be installed where heavy machineries are deployed.

Being Complied.  
All the necessary measures are being taken.

xi)	Proper and prior planning, sequencing and scheduling of all major construction activities shall be done. Construction material shall be stored in covered godowns / sheds. Trucks carrying soil, sand and other construction materials shall be duly covered to prevent spillage and dust emission. Adequate dust suppression measures shall be undertaken to control fugitive dust emission. Regular water sprinkling for dust suppression shall be ensured.	Being Complied. Construction material is stored in covered godowns / sheds. Ensuring trucks' carrying soil, sand and other construction materials are covered with tarpaulin. Regular water sprinkling is being done for dust suppression to control dust emission.
xii)	Use of Ready-Mix concrete i.e. recommended for this project. Water demand during construction shall be reduced by use of pre-mix concrete, curing agents and other best practices.	Being Complied. Ready-Mix concrete is being used for construction.
xiii)	Accumulation/stagnation of water shall avoid ensuring vector control.	Being complied.
xiv)	Regular supervision of the above and other measures shall be in place all through the construction phase so as to avoid disturbances to the surroundings.	Being Complied. Regular supervision being done to avoid disturbances to the surroundings.
<b><u>Selection of Materials for Better Energy Efficiency :-</u></b>		
i)	Use of fly ash based bricks/ blocks/tiles/products shall be ensured. Blended cement with fly ash shall be used. The provisions of Notifications regarding use of fly ash must be compiled with issued by Ministry of Environment, Forest and Climate Change, Government of India. Appropriate usage of other industrial wastes shall also be explored. Soil borrow area should be filled up with ash with proper compaction and covered with topsoil kept separately. Fly ash/ pond ash shall be used for low – lying areas filling. In embankments / road construction etc. ash shall be utilized as per guidelines of Ministry of Environment, Forest and Climate Change, Government of India/ Central Pollution Control Board/ Indian Road Congress etc. concerning authorities. The use of perforated brick/ hollow blocks / fly ash based lightweight aerated concrete etc. shall also be ensured so as to reduce load on natural resources.	Being Complied. Fly ash based bricks/blocks/products are being used for construction purpose.
ii)	Construction shall confirm to the requirements of local seismic regulations. The project proponent shall obtain permission for the plans and designs including structural design, standard, safety adequacy of fire fitting equipment's, protection measures for lighting and specifications of all construction works from concerned authority.	Being Complied. Our township project falls under seismic zone-II. We are complying all applicable rule & regulation related to the construction of colony. Permission copy is attached as <b>Annexure-2 A &amp; 2B.</b>



कार्यालय सहायक संचालक, नगर तथा ग्राम निवेश, बलौदाबाजार (उ.प्र.)  
 OFFICE OF THE ASST. DEVELOPER, TOWN & COUNTRY PLANNING, BALODABAZAR (U.P.)

पता - संगम सिंग अस्पताल रोड, जयपुर, पिन 30. 00  
 कॉम्प्लेक्स, सिंग अस्पताल-राजपुर(उ.प्र.)  
 फोन नं - 07727-232204  
 ई-मेल - cpwngt@balodabazar@gmail.com

आयुक्त प्रति, /निम्न-17/एल-01/नमानि/2020.  
 बलौदाबाजार, दिनांक / /2020

श्री रायपुर सीमेंट प्लांट,  
 (ईकाई) श्री सीमेंट लिमिटेड),  
 पाणचौरी, सहरील सिंगम,  
 जिला बलौदाबाजार-भाटापारा (उ.प्र.)  
 विकास अनुज्ञा बांछा।  
 संदर्भ :- आपका आवेदन दिनांक 15.07.2020।

उपरोक्त संदर्भित आवेदन पत्र में प्रस्तावित भूमि आवेदक/संस्था श्री रायपुर सीमेंट प्लांट, (ईकाई) श्री सीमेंट लिमिटेड), खपरवीह, सहरील सिंगम, जिला बलौदाबाजार-भाटापारा (उ.प्र.) के ग्राम भस्वाड़ीह, प.र.नं. 13, सहरील सिंगम, जिला बलौदाबाजार-भाटापारा स्थित भूमि खसरा नं 82/1, 82/2, 83, 84/1, 84/4, 84/2, 84/3, 84/5, 84/6, 85/1, 114/1, 85/2, 114/2, 86/2/क, 84/1/ख, 86/2/ग, 86/3, 86/2, 90/3, 87/25, 87/26/2, 87/26/3, 87/25, 87/27, 87/29, 88/1, 132, 90/1, 90/4 + 90/2, 92, 94/1, 94/1क, 94/2, 90/2 + 90/1, 97/8 + 97/12/ग, 95/3, 126, 96, 97/11 + 97/16/ख, 97/12 + 97/14/ख/2, 97/59 + 97/22, 97/2क + 97/8, 97/3 + 97/4/1, 97/10 + 97/18, 97/11 + 97/16/क, 97/5 + 97/22/ग, 97/1 + 97/21, 97/12क, 97/13क, 97/5 + 97/22/ख, 97/8 + 97/20, 97/1 + 97/17, 97/28, 97/9क + 97/19, 97/9 + 97/19/क/1, 97/13क + 96/1, 97/13क/1, 97/9क + 97/19/2, 97/12 + 97/14/क, 97/16, 97/9 + 97/19/2, 116/2, 96/4, 112/17क, 115/1, 117, 126/2, 88, 87/4, 87/5, 95/1, 95/2, 96/4, 95/5, 116/1, 116/3 जमाख रकबा 0.370, 0.370, 0.178, 0.036, 0.105, 0.101, 0.067, 0.035, 0.036, 0.070, 0.217, 0.296, 0.218, 0.526, 0, 405, 0.065, 0.202, 0.174, 0.134, 0.128, 0.047, 0.200, 0.243, 0.121, 0.332, 0.133, 0.134, 0.348, 0.697, 0.202, 0.020, 0.121, 0.181, 0.286, 0.202, 0.324, 0.121, 0.190, 0.138, 0.186, 0.194, 0.603, 1.528, 0.272, 0.316, 0.284, 0.093, 0.506, 0.421, 0.283, 0.291, 0.263, 0.526, 0.081, 0.133, 0.256, 0.328, 0.811, 0.137, 0.129, 0.384, 0.187, 0.099, 0.340, 0.579, 0.216, 0.077, 0.101, 0.129, 0.963, 0.664, 0.462, 0.202, 0.162, 0.081, 0.587, 0.120 है। कुल खसरा 77 गुन रकबा 20.419 है। पर आवासीय (रिजिस्टर्ड प्रोजेक्ट) विकास को किंचितप्रति करने की अनुज्ञा छ.ग. भूमि विकास नियम, 1984 के नियम 27 के तहत निम्नलिखित शर्तों के अन्तर्गत शर्तें हूए प्रदाय किया जाता है :-

1. (अ) यदि छ.ग. भू-राजस्व दरिया, 1959 की धारा 172 के तहत भूमि का भू-उपयोग करना आवश्यक हो, तो संबंधित विभाग से व्यवहृत किया जावे।
2. (ब) छ.ग. नगर मालिक अधिकार/छ.ग. ग्राम पंचायत अधिकार/नियम के तहत कोई अनुमति/अनुज्ञा प्राप्त करना हो, तो ऐसी अनुमति प्राप्त करना पुरतः अनिवार्य होगा।
3. यह अनुज्ञा इन शर्तों पर ही जारी है कि आवासीय भूमि आवेदक/संस्था के पूर्ण स्वामित्व एवं अधिकार में है। स्वामित्व संबंधी विवाद के लिए आवेदक/संस्था स्वयं जिम्मेदार होगा। साक्ष्य तथ्य के संबंध में कोई जानकारी अस्वरूप प्राप्त होने पर यह अनुज्ञा स्वयं निरस्त मानी जावेगी, जिसकी संस्था जवाबदारी आवेदक/संस्था की होगी।
4. किसी भी स्थिति में विकास अनुज्ञा को निरस्त/संस्था/निर्माण न किया जावे।
5. कार्यालय कार्यपालन अभियान, ग्रामिण विकास संभाग, छ.ग. ग्रामीण सड़क अभिकरण, जिला बलौदाबाजार-भाटापारा (उ.प्र.) के पत्र क्रमांक 816/ग्रामिण/तक./2020, बलौदाबाजार, दिनांक 19.08.2020 के अनुसार आवेदित भूमि के सम्मुख मार्ग की चौड़ाई 24.00 मीटर है। अतः मार्ग पथ से 12.00 मी. छोड़कर भूमि की सीमा रेखा मानी जावे।

क्रमांक 2 पर

11/2/1

6. शीमांकन में किसी भी प्रकार का परिवर्तन अथवा मध्य में परिवर्तन हो, तो शीमांकित मानचित्र/अभियान इस कार्यालय से सत्यापित कराया जाना आवश्यक होगा।
7. भू-तल बावरेज एरिया मानचित्रानुसार होगा।
8. कहीं क्षेत्र अनुज्ञा 1.25 से अधिक नहीं होगा।
9. छ.ग. भूमि विकास नियम, 1984 के नियम 64 के प्रस्तावों के अनुसार प्रति 100 वर्गमीटर में एक वृक्ष की दर से वृक्षारोपण किया जाना अनिवार्य होगा।
10. ग्राम निर्माण की अनुमति संबंधित कार्यालय से प्राप्त करने के पश्चात ही ग्राम निर्माण कार्य किया जाना होगा।
11. छ.ग. भूमि विकास नियम, 1984 (संशोधन, 2000) के नियम 78 (A) के प्रावधान के अनुसार ऐन वाटर हावर्सिटर की व्यवस्था करना आवश्यक होगा।
12. मानचित्र में किसी भी प्रकार का परिवर्तन/संशोधन मध्य नहीं होगा।
13. शासन के निर्देशानुसार निर्माण कार्य हेतु 25 प्रतिशत फ्लॉर ऐश बिल्डिंग का प्रयोग किया जावे तब निर्माण कार्य में फ्लॉर ऐश बिल्ड जैसे सीमेंट या कॉन्क्रीट फ्लॉर ऐश बिल्ड का सीमेंट या टार्टलस या बले फ्लॉर ऐश बिल्ड, ब्लॉक्स या टार्टलस या सीमेंट फ्लॉर ऐश बिल्ड या ब्लॉक्स का सामान उपचार का उपयोग निर्माण कार्य में किया जावे।
14. इस अनुज्ञा का यह आशय नहीं है कि प्रस्तावित भूमि शासकीय या अर्द्धशासकीय विभागों से प्राप्ता की जाने वाली अनुमति/संज्ञा से मुक्त है अर्थात् यदि किसी प्रकार की अनुमति प्राप्त करना हो, तो ऐसी अनिवार्यता इस अनुज्ञा से प्रभावित नहीं होगी।
15. किसी भी स्थिति में विकास अनुज्ञा स्वयं निरस्त मानी जावेगी।
16. भूमि स्वामी द्वारा शासकीय भूमि जैसे घर, सड़क, सार्वजनिक स्थल, खुला क्षेत्र, पार्क एवं निजी भूमि होने पर अधिकारण न किया जावे एवं अन्य उपयोग में नहीं लिया जावे। ऐसी स्थिति में विकास अनुज्ञा स्वयं निरस्त मानी जावेगी।
17. छ.ग. नगर तथा ग्राम निवेश (संशोधन) अधिनियम, 2010 की धारा-33 में विहित प्रावधानों के अनुसार यह अनुज्ञा शीमांकित दिनांक से 01 वर्ष तक प्रभावशील रहेगी। निर्धारित कालावधि में विकास/निर्माण कार्य पूर्ण न होने पर यह अनुज्ञा को वर्षानुवर्ष क्रियान्वयन करना होगा, जिसकी मुल जायति प्रथम अनुज्ञा दिनांक के अधिकतम 05 पांच वर्षों तक हो सकेगी।
18. जनसंचालन/स्वास्थ्य विभाग की स्थिति में यह अनुज्ञा स्वयं निरस्त मानी जावेगी।
19. इस किसी भी धारा में भू-स्वामित्व जगिदख न माना जावे।
20. भूमि में आवेदित भूमि पर किसी आदिवासी का स्वामित्व धार्य जाने एवं भू-राजस्व संविदा, 1959 की धारा 165(a) का उल्लंघन धार्य जाने पर यह अनुज्ञा स्वयं निरस्त मानी जावेगी।
21. 1. भूखंड में किसी भी प्रकार के भवन निर्माण/पुनर्निर्माण/ग्राम को निरस्त के दौरान पर्यावरण संरक्षण एवं जनसुखा तथा स्वास्थ्य के दृष्टिकोण से प्रदूषण की संभावना हेतु निर्माणधीन भवन के चारों ओर भूखंड अवरुद्ध लगाया जाना आवश्यक होगा। जिसमें निर्दिष्टित सम्मति होगी - स्थल की आवश्यकता अनुसार ब्लॉक 2 भूमि स्वामी द्वारा अपने उत्तर दाहिने अथवा बाईं तरफ का फलन नही होने की शर्त में फलसंगत भूमि विकास नियम 1984 के नियम 31 (3) के अनुसार कार्यवाही की जावेगी।
22. यह अनुज्ञा स्वास्थ्य विभाग के शीमांकन प्रतिवेदन, आवेदक/संस्था के द्वारा प्रस्तुत प्रस्तावित भूमि की स्थिति जो बलौदा अनुसार स्थल निर्माण एवं राजस्व निरीक्षण का शीमांकित रिपोर्ट के आधार पर दी जा रही है। किसी भी प्रकार की विन्यास धार्य जाने पर आवेदक/संस्था स्वयं जिम्मेदार होगा। उसकी लिए इस विभाग की कोई जवाबदारी नहीं होगी तथा प्रदाय की गई विकास अनुज्ञा स्वयं निरस्त मानी जावेगी।
23. आवासीय परिवार/टाउनशीप/उद्योग/व्यावसायिक व्यवस्था हेतु यदि न उक्त परिवार से उत्पन्न होने वाले दूषित जल उपचार हेतु सीवेज ट्रीटमेंट प्लांट (STP) की स्थापना एवं नियमानुसार पर्यावरण संरक्षण मंडल से अनुमति प्राप्त किया जाना आवश्यक होगा।
24. छ.ग. शासन/संचालनालय/इस कार्यालय द्वारा समय-समय पर जारी आदेशों/निर्देशों का पालन करना आवेदक/संस्था के लिए बाध्यकारी होगा।

क्रमांक 3 पर

11/3/1

24. छ.ग. भूमि विकास नियम, 1984 के नियम (अ) के अनुसार तथा शासन/संचालनालय, नगर तथा ग्राम निवेश के द्वारा जारी दिशा निर्देशों के अनुसार शीर शर्तों का पालन करना अनिवार्य है।
25. स्थानिक अधिनियम/नियम के संश्लेष नियमों का पालन करते हुए निर्माण कार्य किया जावे।
26. पाया स्तर पर्याप्त सामाजिक विधायन प्राधिकरण (छ.ग.) द्वारा सड़क, पर्यावरण एवं जनसुखा एवं परिवहन मंत्रालय के पत्र क्रमांक/1218/एन/ईआई/एए/छ.ग./सिटीशिवत प्रोजेक्ट/ब.सा./2147, तथा रायपुर दिनांक 22.12.2016 का पालन सुनिश्चित करना अनिवार्य होगा।
27. शासन सरकार, ग्राम एवं राजस्व मंत्रालय, ग्राम सुखा महाविदेशालय, बिलासपुर क्षेत्र, बहालवादी क्षेत्र, बिलासपुर (उ.प्र.) के पत्र क्रमांक 1254 बिलासपुर, दिनांक 27.06.2020 के अनुसार जॉन क्रमांक 03 एवं 04 जो कि जैंगर जॉन के अंतर्गत है। अतः स्टाफ क्वार्टर एवं जॉन क्रमांक 03 एवं 04 के मध्य 300 मी. तक किसी प्रकार का उत्खनन या अन्य कार्य पूर्णतः प्रतिबंधित रहेगी।
28. अनुज्ञा की शर्तों का उल्लंघन होने अथवा किसी अस्वरूप जानकारी अथवा भू-स्वामित्व के विवाद की स्थिति में इस भूमि पर प्रदत्त विकास अनुज्ञा छ.ग. भूमि विकास नियम, 1984 के नियम 28 के तहत प्रतिस्तुत की जा सकेगी।

संदर्भ :- मानचित्र 01 प्रति।

सहायक संचालक  
 नगर तथा ग्राम निवेश  
 बलौदाबाजार (उ.प्र.)

पु. क्रमांक प्रतिस्थिति 1165/नियम-17/एल-01/नमानि/2020.  
 बलौदाबाजार, दिनांक 07/10/2020

1. संचालक, नगर तथा ग्राम निवेश, (उ.प्र.) नगर रायपुर शहर नगर की ओर कृषय सुचनाएं।
2. अनुदेशाधिकार अधिकारी (उ.प्र.), सिंगम, जिला बलौदाबाजार-भाटापारा (उ.प्र.) की ओर कृषय सुचनाएं।
3. कार्यपालन अभियान, छ.ग. राज्य विद्युत मंडल, बलौदाबाजार, जिला बलौदाबाजार-भाटापारा (उ.प्र.) की ओर कृषय सुचनाएं।
4. जिला पर्यटक, जिला बलौदाबाजार-भाटापारा (उ.प्र.) की ओर कृषय सुचनाएं।
5. संचालक, ग्राम पंचायत, बलौदाबाजार, जिला बलौदाबाजार-भाटापारा (उ.प्र.) की ओर कृषय सुचनाएं।

सहायक संचालक  
 नगर तथा ग्राम निवेश  
 बलौदाबाजार (उ.प्र.)

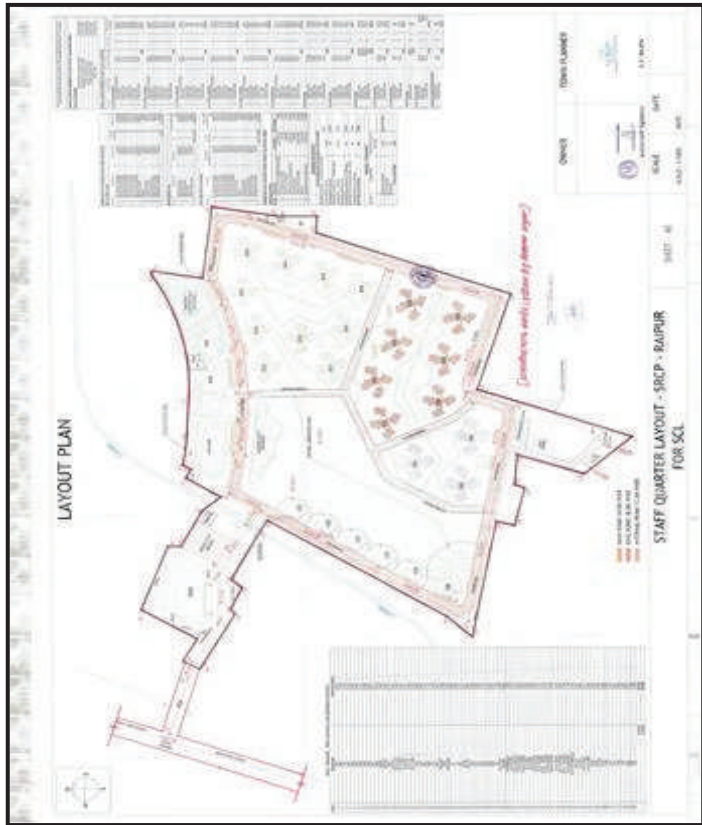

iii)	Reduce the use of glazed surface as per National Building Code 2005. Use of glass in various buildings may be reduced up to 40 % to reduce the electricity consumption and load on air- conditioning. If necessary, use of high quality double glass with special reflective coating in windows. Roof of the various buildings shall meet prescriptive requirement as per Energy Conservation Building Code by using appropriate thermal insulation material to fulfil requirement. Opaque wall shall meet perspective requirement as per Energy Conservation Building Code which is proposed to be mandatory for all air conditioned spaces while it is inspirational for non-air-conditioned spaces by use of appropriate thermal insulation material to fulfill requirement.	Being Complied.
iv)	Use of energy efficient construction materials to achieve the desired thermal comfort shall be incorporated. The desired level of roof assembling 'U' factor and insulation 'R' value must be achieved. Roof assembling 'U' factor for the top roof shall not exceed 0.4 Watt/sq.m/degree centigrade with appropriate modifications of specifications and building technologies. The provisions of national Building Code 2005 shall be strictly followed.	Being Complied.
v)	Modern electrical power transmission & distribution system shall be installed.	Being Complied. Modern electrical power transmission & distribution system has been installed.
vi)	Street lighting shall be energy efficient. LED light shall be provided in street lighting, garden, public place and houses. LED lights and solar water heating systems shall be provided in the buildings (as required)	Noted.
vii)	Extensive network of cellular phones and landline shall be provided. The telephone and electric cables shall be laid in the same corridor. Adequate vertical and horizontal separation between telephone and electric cable shall be maintained.	Noted.
viii)	Reduced hard paving – Onsite (open area surrounding building premises) and/or provide shade on hard paved surfaces to minimize heat island effect and imperviousness of the site.	Being Complied.
ix)	All air- conditioned buildings (if any) shall follow the norms proposed in ECBC regulations framed by the bureau of Energy Efficiency. Use of Chillers shall be CFC & HCFC free.	Noted.
(x)	Power requirement shall be met through Chhattisgarh State Electricity Distribution Company Limited. Power backup shall be D.G. Sets, which should be acoustically proof and eco-friendly.	Being Complied. Power requirement is being met through Chhattisgarh State Electricity Distribution Company Limited. For Power backup D.G. Set has been installed with acoustic enclosure.
xi)	The buildings shall have adequate distance among them to allow movement of fresh air and passage of natural light, air and ventilation.	Being Complied.
xii)	During Maintenance, energy efficient electric light fittings &	Being Complied.



	lamps – low power ballasts, low consumption high power luminaries, lux level limiters & timers for street lighting shall be provided. Used LED's shall be properly collected and disposed off/sent for recycling as per the prevailing guidelines/rules of the regulatory authority to avoid mercury or other contamination. A report on the energy conservation measure conforming to energy conservation norms finalized by Bureau of Energy Efficiency shall be prepared incorporating details about building materials & technology, 'R' value & 'U' factors etc.	
	<b><u>Water Body Conservation :-</u></b>	
i)	Improvement or rehabilitation of existing natural streams, channels / nallas falling within premises (if any) shall be carried out without disturbing the ecological habitat.	Not applicable.
ii)	No untreated / treated waste water shall be discharged in the any water bodies under any circumstances.	Being Complied. Domestic waste water is being treated in STP and treated water is being used for plantation purpose.
iii)	All the construction and preparatory activities shall be carried out during dry seasons only.	Being Complied. All the construction and preparatory activities are being carried out during dry seasons only.
	<b><u>Water Supply: -</u></b>	
i)	Project proponent shall provide adequate measuring arrangement at the inlet point of water uptake and at the discharge point for the measurement of water utilized in different categories to monitor the daily water consumption. Measuring arrangement for effluent generated shall also be provided.	Being Complied. Water meters has been provided at the inlet point of water uptake and at the discharge point for the measurement of water utilized in different categories to monitor the daily water consumption. Water Flow meter for measurement of effluent generated is provided.
ii)	Water saving practices such as usage of water saving devices / fixtures, low flow flushing system, sensor based fixtures, pressure reducing devices etc. shall be adopted.	Being Complied. Water saving practices like water saving devices/ fixtures, low flow flushing system etc. is adopted.
	<b><u>Greening Programme :-</u></b>	

i)	<p>Lay out of proposed buildings and roads etc. shall be made in such a way that it shall cause minimum disturbance to existing flora and fauna. Appropriate green belt shall be developed to compensate the habitat loss of trees for site clearing. The project proponent must obtain permission for tree cutting from competent authority as per prevailing act/rules. Plantation along the side of the roads and in the open spaces shall be developed to act as sinks of air pollutants. Adequate plantation programme along the roads and open spaces shall be planned. The plantation programme shall be drawn to confirm the natural climate conditions. The plantation shall consist of mixture of available indigenous, fast growing and sturdy species of trees, shrubs and herbs as proposed by the project proponent. Plantation shall be done in open spaces available within the premises. Trees of species like sagon, khamar etc which remain leafless for long time shall be avoided.</p>	<p>Being Complied. Plantation along the side of the roads and in the open spaces are being developed. Please refer the following photographs.</p>
----	---	---





	<b><u>Sewage Management:-</u></b>	
i)	Sewage Treatment plant with adequate capacity shall be installed. Sewage collection system of adequate capacity to convey the sewage during peak hours shall be laid to collect and convey the sewage from various buildings. The augmentation of STP shall be ensured before the completion of the buildings.	Being Complied. STP capacity of 350 KL/ Day & 150 KL/ Day have been installed for treatment of domestic waste water.
ii)	Domestic waste water after treatment shall be used in plantation and other uses. Zero discharge condition shall be maintained.	Being Complied. Domestic waste water after treatment is being used for plantation and other uses. Zero discharge condition is being maintained.
	<b><u>Rain Water Harvesting Scheme:-</u></b>	
i)	Rain water from open spaces shall be collected and reuse for landscaping and other purposes. Rooftop rainwater harvesting shall be adopted for the buildings. Every building shall have rainwater harvesting facilities. The storm water flowing in roadside drains shall also be recycled and reused to maintain the vegetation and treatment must be done to remove suspended matter and oil & grease. Rainwater harvesting pits shall be constructed as per proposal.	Rain Water harvesting pond of 20,000 KL capacity has been developed. The photograph of the Rain Water harvesting pond is attached as <b>Photo no. 1.</b>

**Photo no. – 1**





	<b>Transport Management:-</b>	
i)	Appropriate access shall be provided for physically challenged people in the pedestrian paths.	Being Complied. Appropriate access have been provided for physically challenged people in the pedestrian paths.
ii)	Traffic congestion near the entry and exit points from the roads adjoining the project site must be avoided. The design of service roads and the entry and exit from the building shall conform to the norms & standards prescribed by the National Highways authority of India / State public Works Development.	Being Complied.
iii)	Permeable (porous) paving in the parking areas and walkways & patio areas shall be used to control surface water runoff by allowing storm water to infiltrate the soil and return to ground water.	Being Complied.
iv)	The road drainage shall be designed to enable quick runoff of surface water and prevent water logging. The road level shall be kept at least 0.5 to 1.0 meter above the observed high flood level. The guidelines on urban drainage, IRC:SP-50 shall be followed. On the both sides of all roads, well –lit and smooth Will be complied. surfaced footpaths shall be provided. The hoardings shall be strictly prohibited along the roads.	Being Complied.
v)	Adequate provision shall be made to cater the parking needs. Parking shall be fully internalized and no public space be utilized parking spaces standards as given in Manual on Norms and Standards for Environment Clearance of Large Construction Projects, issued by Ministry if Environment, Forest and Climate Change, Government of India shall be adapted.	Being Complied. Fully internalized parking have been provided and No public space will be utilized as per the Norms and Standards for Environment Clearance of Large Construction Projects, Issued by Ministry of Environment, Forest and Climate Change, Government of India.
	<b>Others:-</b>	
i)	All mandatory approvals and permissions as required shall be obtained.	Being Complied. All the necessary permission will be obtained.
ii)	Unskilled construction labourers shall be recruited from the local areas. Constructions materials shall be procured locally as far as possible.	Being followed.
iii)	Water heating system provided in the residential units and common buildings (if any) shall be 100% solar based only.	Being Complied.
iv)	Provision of composting for the biodegradable solid wastes as well as the large amount of biomass that shall be available from the tree plantation shall be made.	Being Complied.
v)	The ground water shall not be abstracted without prior permission from the competent authority in the project area.	Being Complied.



vi)	Adequate roadside drains shall be provided along the road to facilitate its better maintenance and increase in the life of the carriageway, which shall avoid soil erosion and land degradation due to water stagnation. The roadside drains shall be provided on both sides of the road, Longitudinal and cross drainage system shall be regularly maintained. Adequate new drainage works and cross drainage structures shall be provided for smooth passage of runoff. Filling of existing natural drainage courses shall be strictly avoided. Suitable drainage at construction site and camp shall be provided to eliminate the formation of stagnant water pools.	Being Complied.
vii)	Regular supervision of the above and other measurement for monitoring shall be in place all through the construction phase, so as to avoid disturbance to the surroundings.	Being Complied. Regular supervision being done to avoid disturbances to the surroundings.
II.	<b><u>Operation Phase</u></b>	
	<b><u>Sewage treatment plant :-</u></b>	
i)	Project proponent shall operate and maintain the sewage collection/ conveyance system , sewage pumping system (if any) and sewage treatment system regularly to ensure the treated effluent quality within the standards prescribed by Ministry of Environment, Forest and Climate Change, Chhattisgarh of India or prescribed by Chhattisgarh Environment Conservation Board (which ever stringent) All the effluent treatment system shall be kept in good running conditions all the time and failure (if any), shall be immediately rectified without delay, otherwise same alternate arrangement shall be made for storage of untreated sewage until the control measure are rectified to achieve the desired efficiency. Project proponent shall install separate electric metering arrangement with time totalized for the running of pollution control systems. The record (logbook) of power & chemical consumption for running the pollution control systems shall be maintained.	Being Complied. STP capacity of 350 KL/ Day & 150 KL/ Day have been installed for treatment of domestic waste water and treated water is being used for plantation purpose. Please refer <b>Annexure-3</b> .



Sr. No.	Parameters	Prescribed Limit	Apr-22	May-22	Jun-22	Jul-22	Aug-22	Sep-22
1	pH	5.5 - 9.0	7.82	7.8	7.52	7.8	7.6	7.81
2	Total Suspended Solids (TSS)	100	22	12	12	25	14	10
3	Biochemical Oxygen Demand (BOD)	250	10.8	15.8	12.4	12.6	16.8	8
4	Chemical Oxygen Demand (COD)	30	22.46	42.4	30.6	42.7	40.2	22
5	Oil & Grease	10	<2.0	<2.0	<2.0	<2.0	<2.0	<2.0
6	Fecal coliform (FC)	1000	<100	<100	<100	<100	70	<100

#### Municipal Solid Waste/Other Wastes :-

i)	Three-chambered container or three bins (one for bio degradable, one for non-bio degradable and one domestic hazardous waste) shall be placed at appropriate distance on the roadside and inside building. Covered dustbins/garbage collector in convenient places to collect the municipal solid wastes shall be provided.	Being Complied. Separate dust bins (one for bio degradable, one for non-bio degradable, one for other waste ) have been placed at appropriate distance on the roadside and inside buildings.
ii)	The proponent must develop the Solid Wastes Segregation, Collection, Handling, Transportation and Disposal Scheme ensuring safe and scientific Segregation, collection, handling, transportation and disposal of organic and inorganic portion, the organic waste is to be composted/ Vermi composted at the compost plant, the sludge generated from Sewage Treatment Plant (after drying) shall be used as manure for gardening purpose. Dry solid waste and recycling of all recyclable wastes such as newspaper, aluminum cans glass bottles , iron scrap and plastics etc. shall be ensured, All municipal solid wastes shall be segregated , collected, transported, treated and disposed as per provisions of the solid waste management rules, 2016.	Being Complied. Organic waste is converted into compost and used as manure in green belt development. The sludge generated from Sewage Treatment Plant (after drying) is being used as manure for gardening purpose. Dry solid waste is being segregated , collected, transported, treated and disposed as per provisions of the solid waste management rules, 2016.

iii)	Public awareness programmes of benefit if living a clean and healthy life by proper management of solid wastes shall be organized regularly.	Being Complied. Public awareness programmes of benefit of living a clean and healthy life are organized regularly.
iv)	All hazardous wastes (if any) shall be segregated, collected, transported, treated and disposed as per provisions of the Hazardous and other wastes (Management and Trans boundary Movement) Rules,2016.	Not Applicable. No hazardous waste will be generate from Colony.
v)	The use of hand gloves, shoes and safety dress for all waste collectors and sorters shall be enforced.	Noted.
vi)	Recycling of all recyclable wastes such as newspaper, aluminum cans, glass bottles, iron scrap and plastics etc. shall be encouraged through private participation.	Being Complied.
vii)	Necessary measurement shall be made to mitigate the odour problems from solid wastes processing plant.	Noted.
	<b>Others:</b>	
i)	Project proponent shall make arrangement for collection, segregation , transportation and disposal of solid wastes generating during the operational phase as per provisions of the solid Waste Management Rules,2016, before the commissioning of the project.	Being Complied. Separate dust bins (one for bio degradable, one for non-bio degradable and one for other waste) has been placed at appropriate distance on the roadside and inside buildings. Organic waste is being converted into compost and used as manure in green belt development. The collected waste is being disposed through scientific manner.
ii)	Project proponent shall make all necessary safety measures like firefighting, accident prevention etc. before the commissioning of the project.	Being Complied. All necessary safety measures adopted like firefighting teams, fire brigade, fire extinguishers, emergency preparedness etc.
iii)	Noise shall be controlled to ensure that it does not exceed the prescribed standards. During night time the noise level measured at the boundary of the building shall be restricted to the permissible levels to comply with the prevented regulations.	Being Complied. All the noise control measures have been adopted. Noise monitoring report enclosed as <b>Annexure-4.</b>

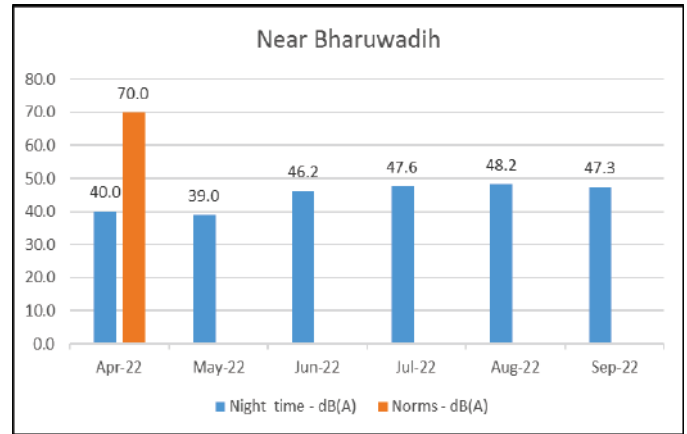
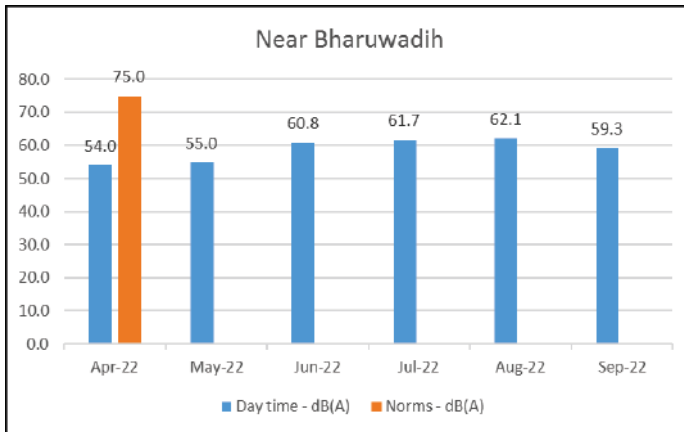

Shree Raipur Cement Plant Noise Monitoring Report			
S No.	Location	Near Bharuadih)	
	Month	Day Time - dB(A)	Norm - dB(A)
1	Apr-22	54.0	75
2	May-22	55.0	
3	Jun-22	60.8	
4	Jul-22	61.7	
5	Aug-22	62.1	
6	Sep-22	59.3	

Shree Raipur Cement Plant Noise Monitoring Report			
S No.	Location	Near Bharuadih)	
	Month	Night Time - dB(A)	Norm - dB(A)
1	Apr-22	40.0	70
2	May-22	39.0	
3	Jun-22	46.2	
4	Jul-22	47.6	
5	Aug-22	48.2	
6	Sep-22	47.3	

iv)	Weep holes in the compound walls shall be provided to ensured natural drainage of rain water in the catchment area during the monsoon period.	Being Complied. Rain water harvesting pond capacity of 20,000 KL with internal drainage line has been constructed in colony.
v)	The ground water level and its quality shall be monitored regularly in consultation with Central Ground Water Authority.	Being Complied. The ground water level & quality being monitored regularly. The monitoring report of the same is attached as <b>Annexure – 5 &amp; 6 respectively.</b>



## Ground Water Level Monitoring Report (bgl) in meter

Sr. No.	Month	AWLR-Near Old Mines Gate Level (M)	AWLR-Near Khapradih Gate (M)	AWLR-Near Crusher -1 (M)	AWLR-Near AAQMS 3 (M)	AWLR-Near AAQMS-2 (Semradih Village) (M)	AWLR-Near AAQMS-4 (Khapradih Village) (M)
1	Apr-22	15.84	31.12	19.34	7.00	14.92	36.10
2	May-22	10.91	17.16	15.94	7.90	11.75	28.71
3	Jun-22	12.07	15.83	16.24	6.76	10.15	25.19
4	Jul-22	5.24	8.32	8.58	6.50	8.71	16.74
5	Aug-22	2.61	4.65	5.30	6.17	6.04	11.51
6	Sep-22	2.01	5.19	5.76	4.97	7.58	13.00

## Ground Water Quality Monitoring Report (May, 2022) IS: 10500:2012

S No	Parameters	Unit	Permissible Limit	Bharwadih	Mine Pit-2 RWH Pond
1	Colour	Hazen	15	<5	<5
2	Odour	-	Agreeable	Unobj.	Unobj.
3	Taste	-	Agreeable	Agreeable	Agreeable
4	Turbidity	NTU	5	< 1	<1
5	pH	-	6.5 – 8.5	7.06	7.79
6	Conductivity	µS/cm	-	1191	517
7	Free Residual Chlorine	mg/L	1	< 0.1	<0.1
8	Total Dissolved Solids	mg/L	2000	682	305
9	Phenol (as C <sub>6</sub> H <sub>5</sub> OH)	mg/L	No Relaxation	<0.001	<0.001
10	Total Hardness (as CaCO <sub>3</sub> )	mg/L	600	372	148
11	Total Alkalinity (as CaCO <sub>3</sub> )	mg/L	600	414	110
12	Carbonates (as CO <sub>3</sub> )	mg/L	-	< 1	<1
13	Bi-Carbonate (as HCO <sub>3</sub> )	mg/L	-	414	110
14	Chloride (as Cl)	mg/L	1000	115	61
15	Sulphate (as SO <sub>4</sub> )	mg/L	400	56	53
16	Nitrate (as NO <sub>3</sub> )	mg/L	No Relaxation	10.5	7.5
17	Fluoride (as F)	mg/L	1.5	0.18	<0.05
18	Calcium (as Ca)	mg/L	200	117	40
19	Magnesium (as Mg)	mg/L	100	19	12
20	Sodium (as Na)	mg/L	-	90	45
21	Potassium (as K)	mg/L	-	2.5	2.5

22	Ammonia (as Total NH <sub>3</sub> -N)	mg/L	No Relaxation	<0.05	<0.05
23	Boron (as B)	mg/L	2.4	<0.2	<0.2
24	Chromium (as Cr)	mg/L	No Relaxation	<0.05	<0.05
25	Copper (as Cu)	mg/L	1.5	<0.05	<0.05
26	Manganese (as Mn)	mg/L	0.3	<0.05	<0.05
27	Zinc (as Zn)	mg/L	15	0.16	<0.05
28	Cadmium (as Cd)	mg/L	No Relaxation	<0.003	<0.003
29	Iron (as Fe)	mg/L	No Relaxation	0.21	0.14
30	Lead (as Pb)	mg/L	No Relaxation	<0.01	<0.01
31	Silver (as Ag)	mg/L	No Relaxation	<0.05	<0.05
32	Aluminium (as Al)	mg/L	0.2	<0.03	<0.03
33	Nickel (as Ni)	mg/L	No Relaxation	<0.01	<0.01
34	Arsenic (as As)	mg/L	No Relaxation	<2	<2
35	Total Coliforms	MPN/100 ml	Shall not be detectable in any 100 ml sample	N.D.	N.D.
36	E- Coli	MPN/100 ml	Shall not be detectable in any 100 ml sample	N.D.	N.D.

**PART B – GENERAL CONDITIONS :-**

i)	After approval of the competent authority appropriate firefighting system shall be adapted.	Noted.												
ii)	The environmental safeguard and mitigation measures contained in the application shall be implemented in letter and spirit.	Noted.												
iii)	All the conditions, Liabilities and legal provision contained in the Environmental clearance shall be equally applicable to the successor management of the project in the event of the project proponent transferring the ownerships , maintenance of management of the project to any other entity.	Noted.												
iv)	The project proponent shall make financial provision in the total budget if the project for implementation of the above mentioned conditions and for suggested environmental safeguard measures. The funds earmarked for the environmental protection measures shall not be diverted for other purposes.	<p>Being Complied.</p> <p>The funds earmarked for the environmental protection measures will not be diverted for other purposes. Total environment expenditure incurred during the period from April -22 to September -22 are as under: -</p> <table border="1"> <thead> <tr> <th>SN</th> <th>Particular</th> <th>Amount in Rs.</th> </tr> </thead> <tbody> <tr> <td>1</td> <td>Plantation</td> <td>930000</td> </tr> <tr> <td>2</td> <td>O&amp;M STP</td> <td>325737</td> </tr> <tr> <td colspan="2" style="text-align: center;">Total</td> <td>1255737</td> </tr> </tbody> </table>	SN	Particular	Amount in Rs.	1	Plantation	930000	2	O&M STP	325737	Total		1255737
SN	Particular	Amount in Rs.												
1	Plantation	930000												
2	O&M STP	325737												
Total		1255737												

v)	Six monthly monitoring reports shall be submitted to the SEIAA, Chhattisgarh, Regional office, Ministry of Environment Forest and Climate change, Government of India, Bhopal and Chhattisgarh environment Conservation Board, Naya Raipur who shall be monitoring the implementation of environmental safeguards shall be given full cooperation, facilities and documents / data by the project proponents during their inspection. A complete set of all the documents shall submit to State Level Environment Impact Assessment Authority, Chhattisgarh.	Being Complied. We are regularly submitting Six monthly EC Compliance Report to SEIAA, Chhattisgarh, Regional office, Ministry of Environment Forest and Climate change, Government of India, and Chhattisgarh environment Conservation Board, Naya Raipur (C.G.).
vi)	The responsibility of implementation of environmental safeguards rests fully on the project proponent. Project proponent shall establish an environmental management cell under the supervision of senior executive, directly reporting to the head of organization.	Being Complied. We have established environmental management cell who directly reports to the Unit Head.
vii)	In the case of any change(s) in the scope of the project the project shall require a fresh appraisal by the SEIAA.	Noted.
viii)	The issuance of this letter does not convey any property rights in either real or personal property or any exclusive privileges nor does it authorize any injury to private property or any invasion of personal rights nor any infringement of central, state or local laws or regulations.	Noted.
ix)	All other statutory clearances from Chief Controller of Explosives, fire Department, civil Aviation Department, forest conservation act, 1980 and wildlife (protection) act, 1972 etc shall be obtained as applicable by project proponent. Project proponent shall obtain all necessary statutory clearance /licenses/permissions from concerned central government/state government departments, Boards, Bodies and corporations etc. Project proponent shall follow direction issued by Central government/State Government, Central pollution Board/Chhattisgarh Environment Conservation Board from time to time regarding control of water & air pollution and for environmental conservation.	Being Complied.
x)	The State Level Environment Impact Assessment Authority, Chhattisgarh reserves the right to amend the above conditions and add additional safeguard measures subsequently, if found necessary and to take action including revoking of the environment clearance under the provisions of the environmental (protection) Act.1986 to, ensure effective implementation of the suggested safeguard measures in a time-bound and satisfactory manner.	Agreed.

xi)	<p>The project proponent shall advertise in at least two local newspapers widely circulated in the region around the project , one of which shall be in the vernacular language of the locality concerned within seven days from the date of this clearance letter, informing that the project has been accorded environment clearance and copies of clearance letter are available with the Chhattisgarh Environment Conservation Board and may also seen at Website of the SEIAA, Chhattisgarh at <a href="http://www.seiaacg.org">www.seiaacg.org</a>.</p>	<p>Complied.          Advertised in two local newspapers i.e. Dainik Bhaskar &amp; Hari Bhumi widely circulated in the region around the project on 28.12.16. Copy of newspapers cutting enclosed as <b>Annexure-7</b>.</p>
-----	---	---

Annexure-7



xiii)	<p>A copy of the clearance letter shall be sent by the proponent to concerned panchayat, zila parisad/ municipal corporation, urban local body and the local NGO, if any from whom suggestion / representation, if any, received while processing the proposal. The clearance letter shall also be put on the website of the company by the proponent.</p>	<p>Complied.          Copy of environment clearance letter has been sent to concerned panchayat, zila parisad/ municipal corporation &amp; urban local body.          EC letter has been put on our web site:- <a href="http://www.shreecement.com">www.shreecement.com</a></p>
xiii)	<p>Any appeal against this environmental clearance shall lie with the National Green Tribunal, if preferred, within a period of 30 days as prescribed under section 16 of the National Green Tribunal Act, 2010.</p>	<p>Noted.</p>



**Compliance of MoEFCC Office Memorandum dated 18<sup>th</sup>, July 2022 for Sensitization on implementation of Ban on Single Use Plastic (SUP's)**

**Awareness through fixing of Banners at prominent places of Cement Plant, Mines and**

**Township area**





## Organized Marathon for awareness on No Single Use Plastic at SRCP





## Awareness Programme for workmen and Distribution of Cloth Bags





**Awareness programme for Township residence and Cloth bags distribution**





## Awareness programme at Schools of nearby Villages

